

PARALLEL TWIN SPINDLE PRECISION COMPACT GANG TYPE
CNC LATHE WITH 3-AXIS GANTRY LOADER

L3II-W-NCL



Twin spindle & twin gang type tool post with gantry loader & turn-over device to accommodate various turning applications.

Headstock on Z-axis slide way & turret on X-axis slide are separated to avoid vibration & heat distortion.

Headstock

- High, rigid, built-in motor for superior accuracy
- Super precision bearings tolerate heat & vibration for long machine life
- Special chiller for headstock to minimize heat distortion
- Maximum 6,000 rpm for high speed turning & high accuracy

X & Z-Axis slide

- Dovetail slide ways with Turcite
- Rigid construction with smooth slide & good repeatability
- Rapid feed on X & Z-axes with 20,000mm/min & sub-micron control system to enable speed & precision machining

L3II-W-NCL

■MACHINE STANDARD SPECIFICATIONS

Specification		Unit	L3 II -W-NCL	
Capacity	Max. turnable O.D.	mm(in)	φ 40(φ 1.574)	
	Max. turnable length	mm(in)	50(1.968)	
	Max. chuck size	Inch	6	
Spindle	Number of spindle		2	
	Nose configuration	mm(in)	φ 87(φ 3.425) flat	
	Max. speed	min ⁻¹ (rpm)	6,000	
	Through hole dia	mm(in)	φ 48(1.889)	
Tool post	Number of tool post		2	
	Type		Gang	
	Turning holder	mm(in)	13(0.511)	
	Boring bar holder	mm(in)	φ 25(0.984)	
Travel	X-axis	mm(in)	200(7.874)	
	Z-axis	mm(in)	235(9.251)	
Feed rate	X-axis rapid feed rate	mm/min(IPM)	20,000(787.401)	
	Z-axis rapid feed rate	mm/min(IPM)	20,000(787.401)	
Motor	Spindle motor (30min/cont)	Kw(HP)	5.5/2.2×2(7.3/2.9×2)	
	Servo motor	X-axis	Kw(HP)	1.0(1.33)
		Z-axis	Kw(HP)	2.5(3.33)
	Coolant pump	Kw(HP)	0.4/0.6(0.53/0.8)	
Machine size	Height	mm(in)	2,130(83.85)	
	Floor space(W×D)	mm(in)	2,665×2,560 (104.921×100.787)	
	Weight	kg(lb)	4,000(8,820)	

■CNC UNIT STANDARD SPECIFICATIONS

Specification	Unit	FANUC Series 0: T
Controlled axis		9 axes Simultaneously controllable axis 9 axes(automatic mode)
Least input increment	mm(in)	0.0001(0.00001)
Max. programmable dimensions	mm(in)	±9999.9999(999.99999)
Manual handle feed	mm(in)	0.0001(0.00001), 0.001(0.0001), 0.01(0.001)
Interpolation function		Linear, Taper, Threading, Circular Incremental & Absolute
Part program storage & editing	m(in)	2,560(8,399.36)
Display	in	8.4inch color LCD
Number of register able program		800
Input code		ISO/EIA automatic recognition
Tool offset maount memory		±7digits, 128pairs
Rapid traverse override		4 steps
Reference position		Manual, Automatic

■CNC UNIT STANDARD ACCESSORIES

- Tool geometry and wear offset ●Chamfering/corner R ●Manual pulse generator ●Backlash compensation ●Canned cycles
- Multiple repetitive cycles (G70~G76) ●Run hour and parts count display ●Thread cutting retract ●Continuous threading ●Play back
- Radius designation on arc ●X axis diameter/radius programming
- Constant surface speed control ●Tool nose radius compensation
- Inch/metric conversion ●Custom macro ●Extended program editing
- Unexpected disturbance torque detection function ●Rigid tapping

■CNC UNIT OPTIONAL ACCESSORIES

- External offset input interface ●Reader/puncher interface
- Automatic tool offset

■STANDARD ACCESSORIES

- 3 axis CNC controlled gantry loader 1 set ●2" air chucks and jaws for load/unload 1 set ●Tool holders 4 sets ●Spindle chilling system 1 set
- X-Z axis lubrication system 1 set ●Door lock system 1 set ●Splash guard (with automatic open/close window for loader) 1 set ●Coolant unit 1 set
- Work counter 1 set ●Signal tower 1 set ●Automatic circuit breaker 1 set
- Work light 1 set ●Coolant blow system 1 set ●Hand tools 1 set

■OPTIONAL ACCESSORIES

- W loader ●Work turn-over device
- X axis linear scale(resolution 0.05 micron meter) ●Work supply/discharge conveyor ●20 station indexing stacker ●Pallet changer ●Chip conveyor
- Automatic fire extinguisher ●Duct for mist collector ●Oil mist collector
- Coolant temperature controller ●4" precision air chuck and jaws
- 4" diaphragm chuck and jaw ●Air blow through spindle ●Air blow system
- Tool counter

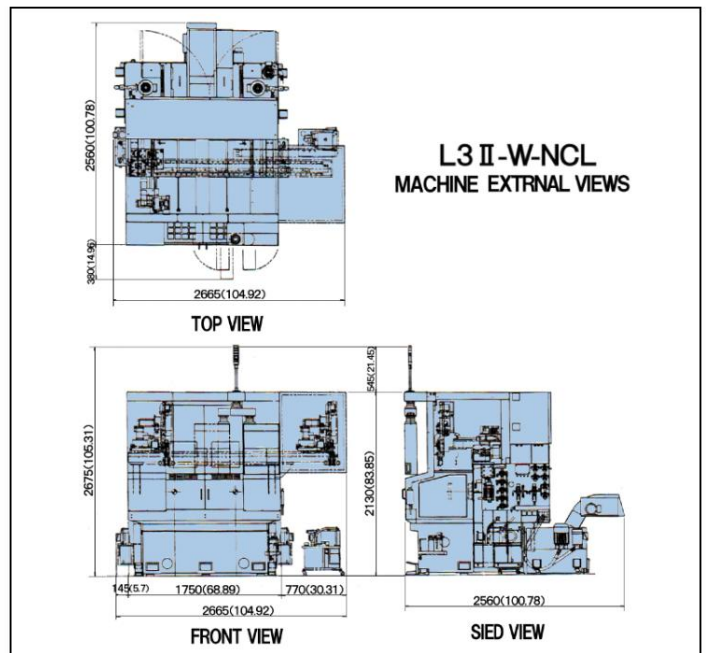

TMW

●Due to continual research and improvement, the above specifications are subject to change without notice.

TAKAHASHI MACHINERY CO., LTD.

<http://www.tmwjp.com>

Head office: 4-11, Aza Shinbo, Ohaza Yamaya, Ojiya-City, Niigata Pref., Japan(947-8506)
TEL(0258)82-4315, FAX(0258)83-2202, E-mail:sales@tmwjp.com

Nagoya branch: EME Nagoya Bldg., 4F, 4-24-8, Meieki, Nakamura-ku, Nagoya-City,
Aichi Pref., Japan(450-0002)
TEL(052)571-5155, FAX(052)561-4966, E-mail: sales-nagoya@tmwjp.com

TAKAHASHI MACHINERY (THAILAND): 2549/32 Phaholyothin Rd., Lardyao, Jatujuk,
Bangkok 10900 Thailand
TEL(662)942-7162, FAX(662)942-7163, E-mail: tmwth@tmwjp.com